



FORMWORKS

RE.PACK produces FORMWORKS in polystyrene foam covered with PVC film, sheet or wood staves in order to allow several uses depending on what the building site needs.

Our expert technicians study all plans and provide detailed laying plans too.

Formworks for cornices are produced in standard size (200 cm or 400 cm), while all other formworks are custom-made.

With RE.PACK formworks, it is possible to produce every architectural detail, as arches, cornices, columns with capitals, vaults and domes.

Here we list all different formworks produced RE.PACK

ITEM OF SPECIFICATION

- FORMWORKS IN EPS

Formworks produced by RE.PACK, are made using polystyrene foam high-density sinterized; on the negative side they are covered with a protective PVC film which allows an easy and rapid removal and eventual re-use of the formwork.

The shape for the concrete casting of the cornice will have these dimensions: cm....x....
(projection x height)



SOME EXAMPLES OF FORMWORKS



FORMWORK WITH PVC

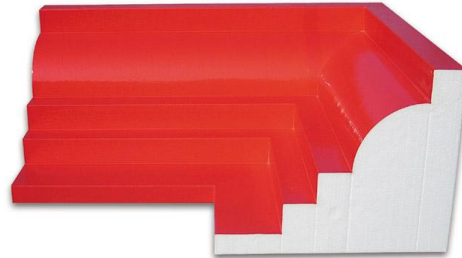

ANGULAR FORMWORK



FORMWORK FOR BALCONY



FORMWORK FOR SPYRAL STAIRCASE

LAYING

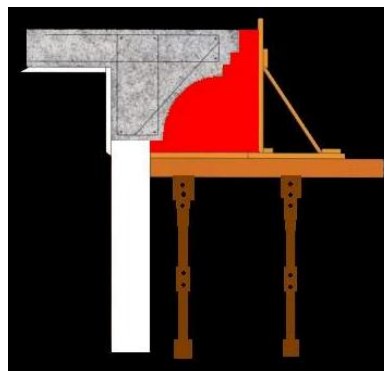
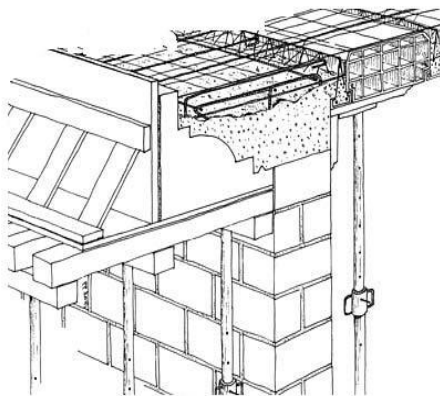

SCHEME OF LAYING WITH SCAFFOLDING FOR THE CONCRETE CASTING

The laying of RE.PACK formwork is carried out with a classic SCAFFOLDING, because the external surfaces of the shape are right-angled, as you can see in the image.
RE.PACK formwork can be used 3 times.

SOME REALIZATIONS IN BUILDING SITE



TYPOLOGIES WE PRODUCE

